

NOTICE

The purchaser agrees when purchasing this plan (the "Plan") that the purchaser has acquired the right to build or construct the project or project set out in the Plan for personal use only and not for any commercial use. 2) reproduction of the Plan in whole or in part by any means whatsoever is strictly prohibited. The Hardwareman should not be liable for any willful misuse or negligent use of this plan, the Project or any tools used to construct the Project or for any loss or damage resulting therefrom.

NOTE: Read all directions before beginning
Compensers glue should be used
to reinforce all joints
Set all nails, countersink all screws.
Dimensions in brackets denote millimeters

Directions

- 1) Lay out your material on the workbench, or on sawhorses, as outlined in the suggested materials layout (Fig. 1). Draw out all parts exactly as illustrated in cutting diagram (Fig. 2), including the letter designations, in pencil. Ensure to leave a small space between cut lines to allow for the width of the saw. Before cutting, double check all measurements to ensure they are correct. Always cut on the waste side of the material to ensure the edges of the pieces are square. The mousing type or clamp on 1/8" material to avoid splintering. The notches can be cut with either a jigsaw, or table saw, or hand saw and chisel. Dry fit all notches to ensure a snug fit before gluing. Wipe off any excess glue at each stage of the project.
- 2) Pre-drill pieces S with three 1/8" holes each, and attach to piece J with six 1 1/4" #6 flathead screws as shown (Fig. 3). Pre-drill the pieces S again with two holes each, and attach to pieces G and H with four 1 1/4" #6 flathead screws as shown (Fig. 4). Attach drawer pull to G centering on G 1 1/8" from top. Countersink screws to allow flush fit of H to G. Glue and nail piece U to H and G with 1 1/2" finishing nails. Glue and nail piece V onto pieces H and U with 1 1/2" finishing nails. Set this drawer aside making sure G is square to H while glue is setting.
- 3) Pre-drill pieces P with five holes each, and glue and screw to piece A with ten 1 1/4" #8 flathead screws as shown (Fig. 5).
- 4) Pre-drill pieces O and R with five holes each, pieces Q and M with eight holes each as shown (Fig. 6). Note that the supports on B and C are slightly different. (There is no piece Q on the drawer side (right) and there is no piece M on the left side). Glue and screw these pieces onto pieces B and C with thirty six 1 1/4" #6 flathead screws.
- 5) Glue and attach pieces B and C to piece A with ten 1 1/2" finishing nails, five each side.

OVER

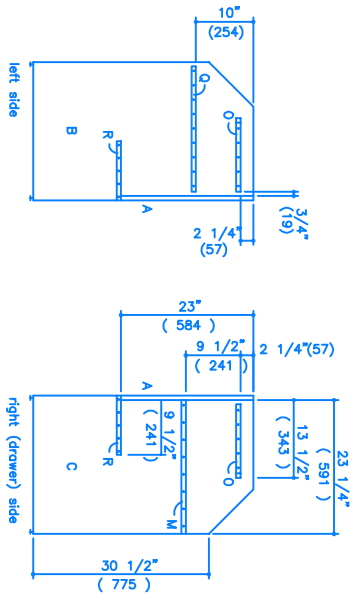
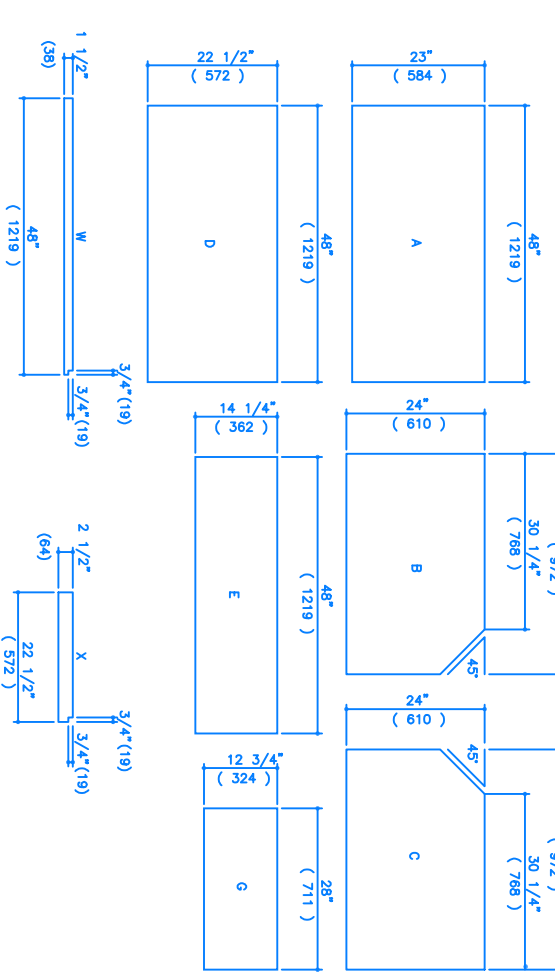
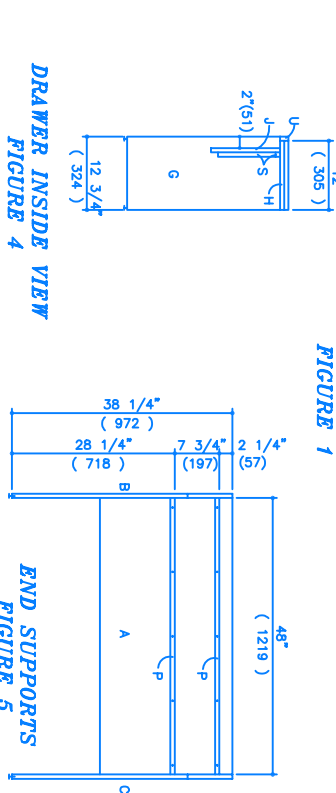
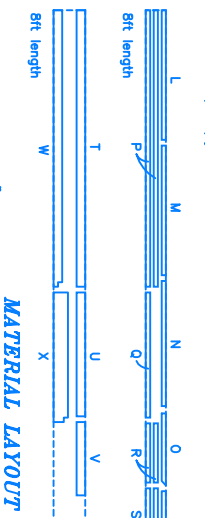
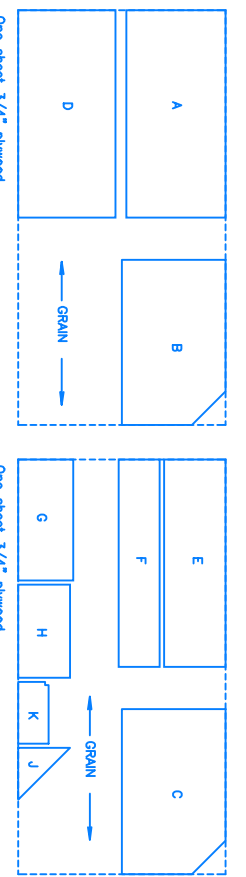
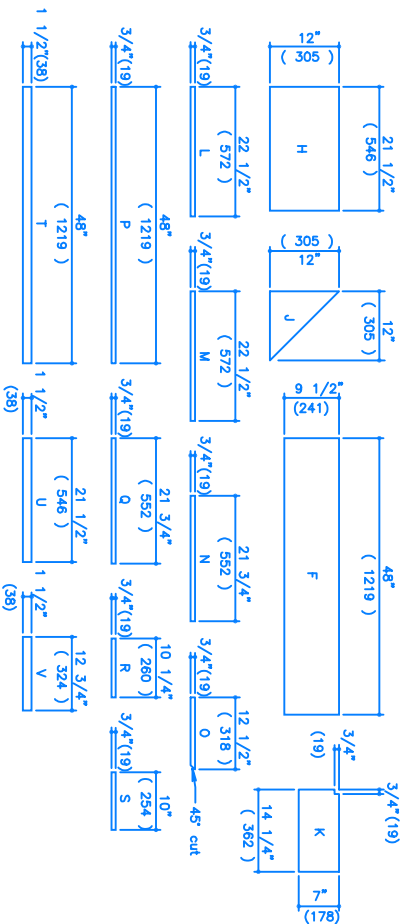

COMPUTER DESK - Project #709

- MATERIALS LIST***
- * Two 4'-8" x 3/4" sheets plywood, G2S (AGA)
 - * One 1"x6"x8" (3/4" x 5'-1/2"x8") hardwood
 - * One 1"x6"x8" (3/4" x 5'-1/2"x8") hardwood
 - * Approx. seventy five 1-1/4" #6 flathead screws
 - * One 2" #6 flathead screw
 - * Approx. 1/2 lb. 1-1/2" Finishing nails
 - * Approx. 1/2 lb. 1-1/4" Finishing nails

- MATERIALS LIST***
- * Sandpaper
 - * 3/32" edge tape
 - * Stain, finish, or oil
 - * Woodfiller
 - * Compensers glue
 - * Drawer pull and hardware

- TOOLS***
- * Tablesaw
 - * 1/8" and countersink drill bit
 - * Power or hand drill
 - * Hammer
 - * Sanding Block
- TOOLS***
- * Screwdriver
 - * Nail set
 - * Jigsaw or hand saw and chisel
 - * Pencil and measuring tape
 - * Putty knife