

# Bookcase plans

## Book Case

Page 1

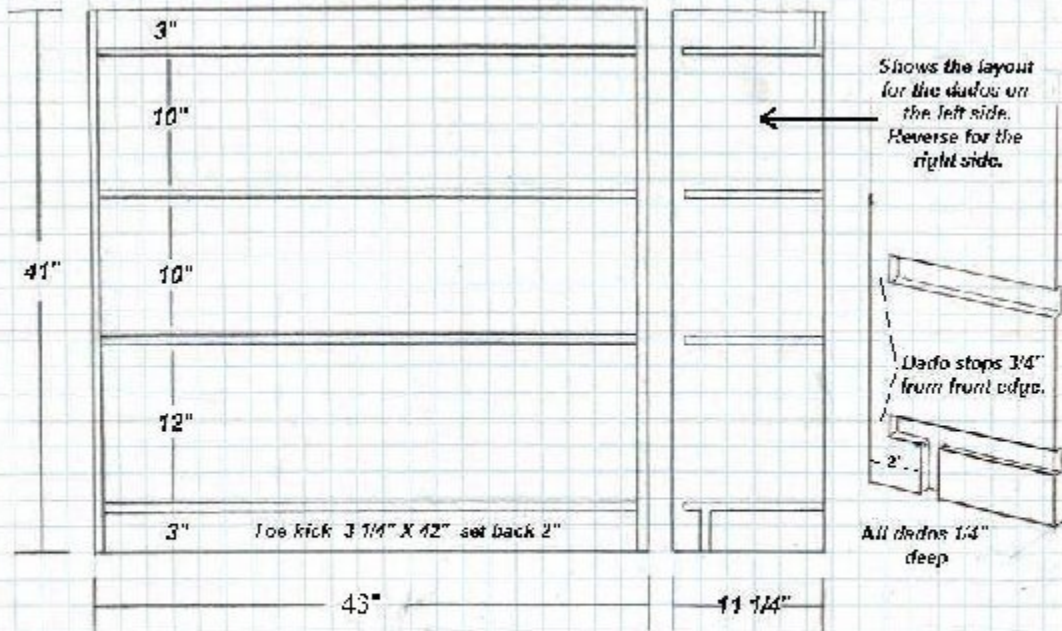

*These dimensions are for a book case I made. You can change the height or the width as you like and still use these plans as a guide, just change the spacing or overall size. Keep the blind dado details as they are, unless you want to change them too!*

Eliminate this dado on the two center shelves.

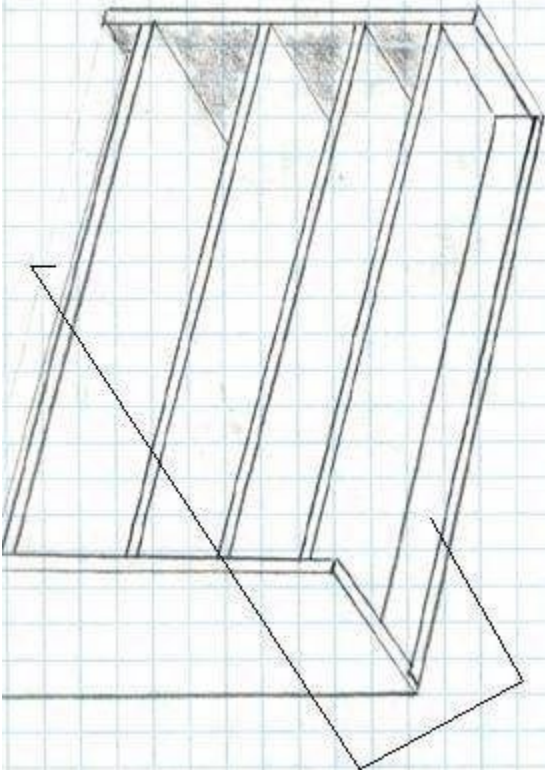
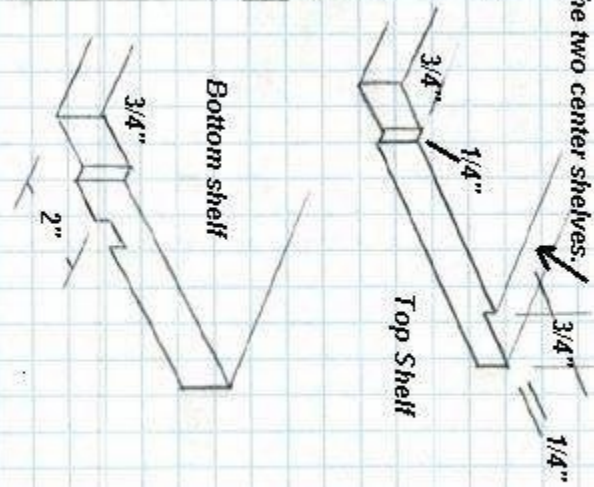
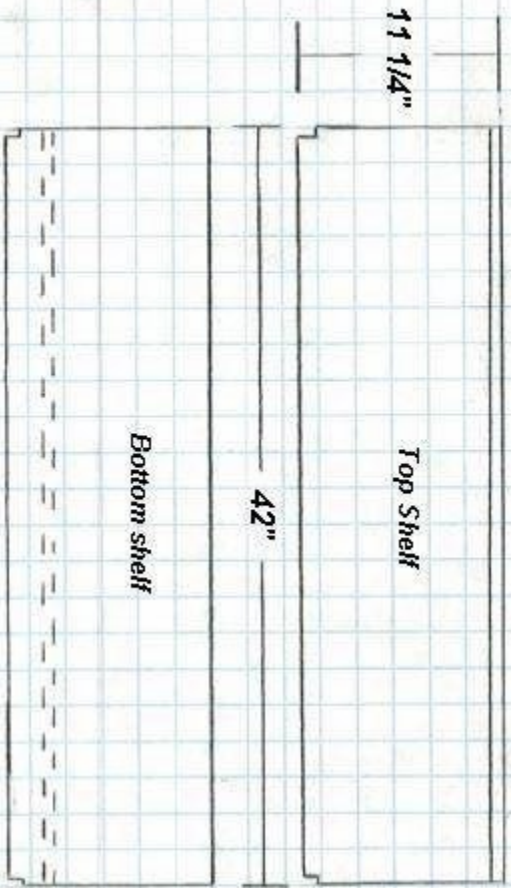

**Cut List**  
All 3/4" stock

- 2 11 1/4 X 41 sides
- 4 11 1/4" X 42 shelves
- 2 3 1/4" toe kick and back of top shelf