

89

# DROP-LEAF TABLE

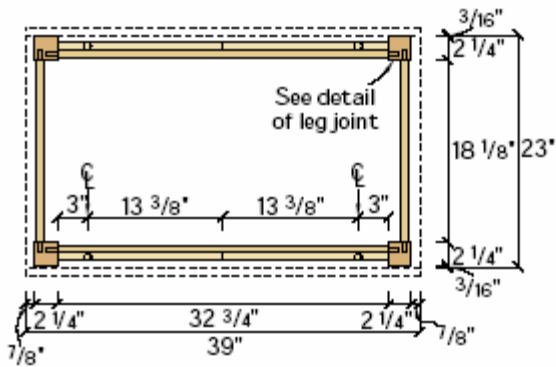



**Schedule of Materials: Drop-Leaf Table**

No.	Item	Dimensions T W L	Material	Notes
1	Table top	3/4" x 23" x 39"	Mahogany	
2	Leaves	3/4" x 15 3/4" x 39"	Mahogany	
4	Legs	2 1/4" x 2 1/4" x 28"	Mahogany	
2	Short aprons	3/4" x 4 1/4" x 20 1/8"	Mahogany	1" TBE; 1/4" offset
2	Long aprons	3/4" x 4 1/4" x 34 3/4"	Mahogany	1" TBE; 1 1/4" offset
4	Leaf supports	3/4" x 3 1/4" x 18"	Mahogany	
2	Triangles	3/4" x 3 1/4" x 6 1/2"	Mahogany	

**Supplies**

- 4 Hinges for drop-leaves; Rockler part number 29249; \$4.29 for 2 hinges
  - 6 Tabletop fasteners; Rockler part number 34215; \$1.99 for 8 fasteners
- Rockler can be reached at [www.rockler.com](http://www.rockler.com) or 800-279-4441

TBE- Tenon, both ends; \* cut to fit

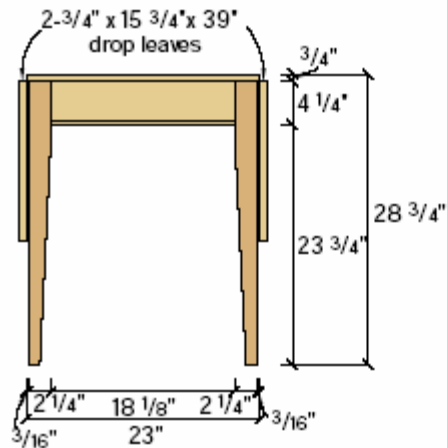
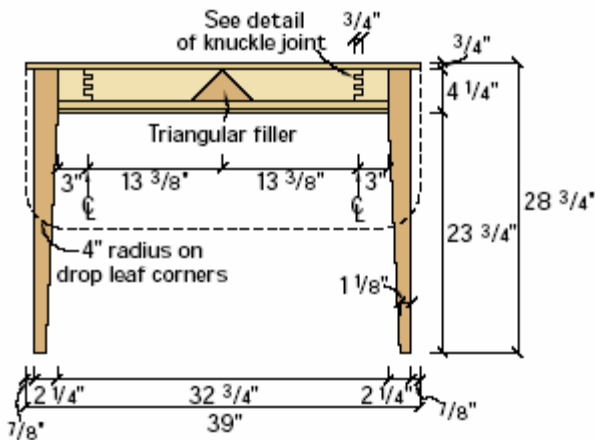

**Start with the Basics**

After cutting all your rough stock to length, surface your wood down to 3/4" thick (except for the legs). The original 19th-century table's top was only one board. You can still find mahogany in these widths, but I couldn't. To obtain the appropriate width, I had to glue up two boards for both the leaves and the tabletop. I used three biscuits at each joint to keep the boards aligned during glue-up. Also, if you can't get 2 1/4"-thick stock for the legs, ask for turning blanks at the lumber store instead; you might just get lucky.

**Mortises, Tenons and Tapers**

The first step is to make mortise-and-tenon joints where the aprons join the legs. I made the tenons using a dado stack on the table saw. Cut the shoulders as shown in the photo on the next page. Make the tenons 3/8" thick, 1" long and 3 1/4" wide. After cutting your tenons, cut a groove in the aprons for the tabletop

fasteners, which will attach the top to the table's base. Make this slot by cutting a kerf in the aprons that's 7/16" down from the top edge. For a nice detail, I routed a bead on the bottom edge of the aprons.

The mortises on all the legs are made 1-7/16" from the inside for the short aprons and 7/16" from the inside for the long aprons as shown in the diagram below. Cut your mortises on the legs; I used a mortiser, but you can use a chisel or Forstner bit.

The original table had turned legs, but in order to simplify things, I tapered the legs. Tapering jigs for the table saw can be tricky, so I used a band saw to cut the tapers about 1/16" shy of my line and then cleaned up the cut on the jointer. The taper should start 1" below where the aprons end and result in a leg that tapers to one-half the original thickness. Remember: taper only the sides that have mortises.

## Install the Hinges

After tapering, sand the legs and aprons. Start with 100-grit sandpaper, move up to 150-grit, then finish with 220-grit. Next, glue up the legs and aprons and clamp. After gluing up the base, turn your attention to the top.

Install the hinges that connect the tabletop to the leaves. Use two on each side, and place them 7¼" inches from the end to allow room for the leaf supports. Lay out the location of the hinges by first placing a 1/16" spacer (I used pieces of plastic laminate) between the leaf and tabletop. Clamp the pieces together, put the hinges down and trace them with a pencil. Use a router with a straight bit to hog out most of the area. Then use a chisel to define the corners. Install the hinges and make sure they work properly.

A 4" radius on the outside corners of the leaves on the original table was a nice touch. In order to recreate this, I traced the curve from the original and made a template using a piece of plywood. Cut the shape to size on a band saw and then use the template with a router and straight bit to finish the radius.

## Make the Leaf Supports

To keep the leaves upright, assemble two supports for each side. These are basically two pieces of wood finger-jointed together to form a "knuckle" joint hinge. The ½" knuckle joints are made on a table saw using a finger-jointing jig. Round the edges of the "fingers" with a rasp or sandpaper so the joint pivots. Then drill a ¼" hole through the fingers and tap a ¼" dowel in place. Instant wooden hinges. One note: you'll have to cut a notch in the two supports so they'll clear the hinge barrels on the top. Mark the location of the notch when you dry-assemble the table. The angle cuts on the supports form a triangular hole against the apron. Cut a triangular piece of mahogany to fill this space, being careful not to let the filler rub against the supports. For simplicity, you may use brass hinges instead of knuckle joints.

## Sanding and Finishing

Remove the hinges from the tabletop and sand the table. Because the top will be the most visible surface, I chose to go up to 220 grit. The bottom requires only 150 grit. In order to simplify finishing, I waited to attach the supports until after finishing. This requires masking off the area where the support will be glued. For the finish, I applied a dark mahogany stain made by United Gilsonite Laboratories (P.O. Box 70, Scranton, Penn. 18501; 800-272-3235; [www.ugl.com](http://www.ugl.com)). The color is called "118 Dark Mahogany," order number 11811, LR1294. Both the phone number and the website can refer you to a retailer in



To cut the tenons, use a dado stack on the table saw. Reduce the tenon in thickness by 3/16" on each side.



Cut ½" shoulders on each side of the aprons.



You will need to fasten the tabletop using tabletop fasteners, which requires making a kerf in the aprons. I made this kerf on the table saw 7/16" from the edge and ¼" deep.

your area. After letting the stain cure, I applied four coats of clear lacquer.

## Final Construction Details

After the lacquer has dried, attach the supports and the triangle with glue and nails through the inside of the aprons. Place the top on the base and make sure the supports keep the leaves level. Now attach the top. Because of the expansion and contraction of wood, you will need to attach the aprons to the tabletop using tabletop fasteners. These fasteners are available from Rockler and are listed in the Schedule of Materials. The tabletop fasteners are installed by simply screwing the fasteners into place. Because the wood will move more in width than in length over time, be sure to leave more space on the long apron sides for the fasteners.

Overall, I was extremely pleased with the results of my project. I think my great-great-grandfather would be proud to know that I've continued the family tradition.



I made the mortises using a mortiser. In order to form the holes more safely, you should think of the path of least resistance. Instead of just going in a straight line from left to right or right to left, make two holes with a slight gap between. Then clear out the gap. If you simply work in a straight line, the mortiser's chisel could bend or break.



I tapered the legs on a band saw, then ran the legs over the jointer in order to make them smooth.