

Deck layout diagram

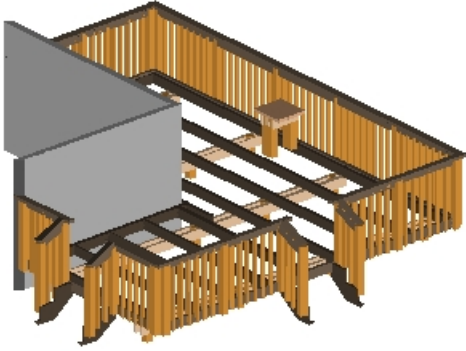

Top view without planks

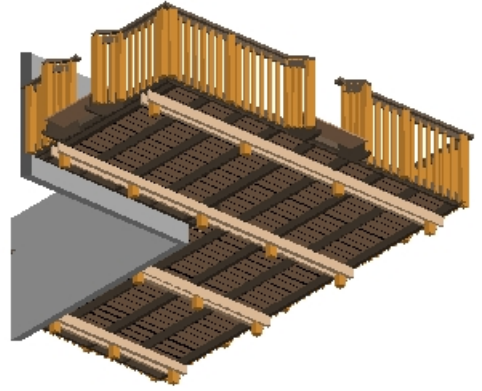

Bottom view with planks

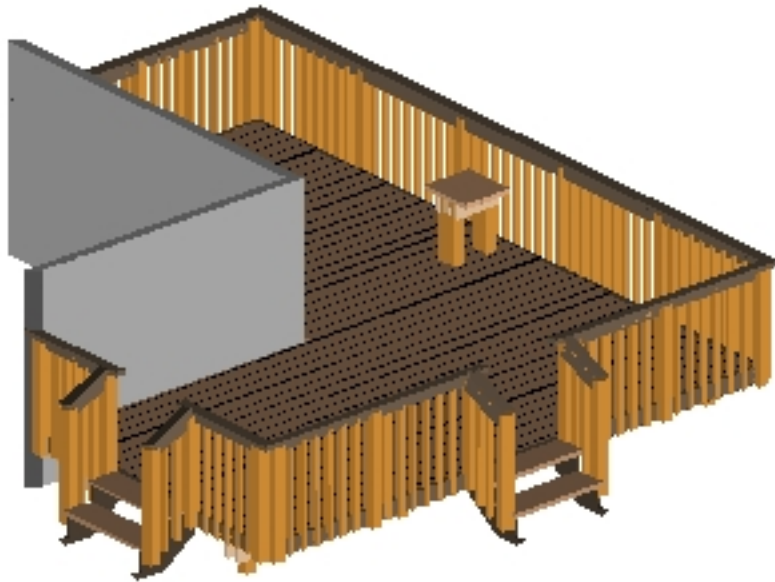

Top view with planks

Deck Part Identification

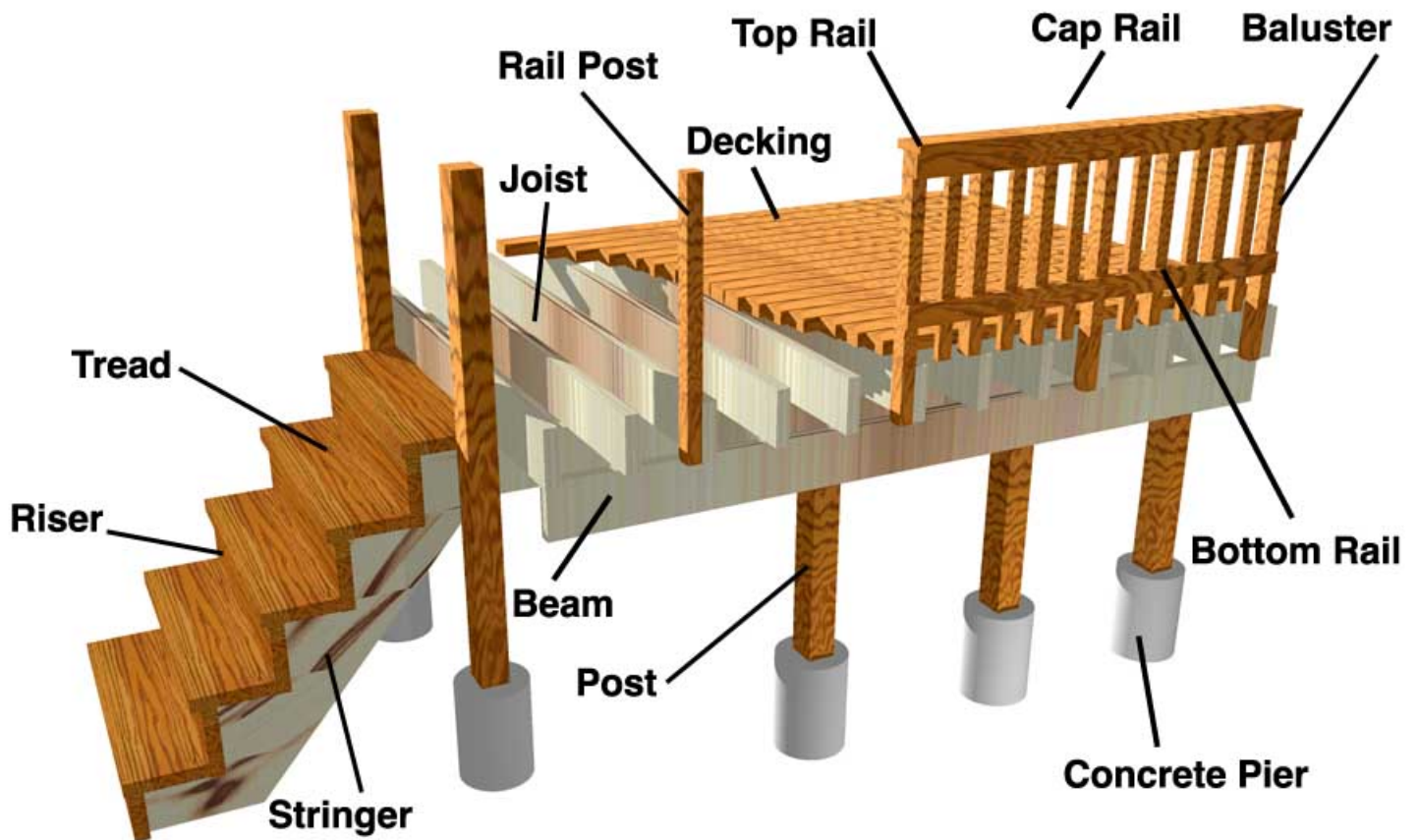

Baluster	The vertical pieces of a railing spaced at regular intervals between posts.
Beam	A horizontal framing piece, which rests on posts and supports joists.
Decking	The boards used to make the walking surface of the deck
Joist	A horizontal frame piece that supports the decking and spreads the weight over the beams
Ledger	A horizontal strip that connects the deck to the house.
Concrete Pier	A vertical piece of concrete, used as a footing to support a post.
Post	A vertical framing piece, used to support a beam or a joist.
Riser	The board attached to the vertical cut surface of a stair stringer.
Stringer	The diagonal board used to support treads and risers on a stairway.
Tread	The horizontal surface of a stair, perpendicular to the riser.
Bottom Rail	The lower horizontal piece that connects rail posts
Top Rail	The upper horizontal piece that connects rail posts
Cap Rail	The top horizontal trim on railing.
Rail Post	The vertical posts connected to the deck framing, to which railing is secured.

Installation Checklist

Building code and zoning requirements

Check deed restrictions, building codes and/or zoning laws to make sure your deck complies.
Check with local utility companies to make sure deck construction will not disturb piping or wiring.

Deck function

While planning your deck, determine how it will be used.

Your climate

While planning your deck, consider local weather.
Take advantage of good views.

Install ledger

Install ledger to anchor deck to house.
Ledger placement determines the deck floor level, normally 2-4" below floor line.
If unsure about attaching a ledger board, consult a professional.
Use batterboards and mason's string to mark off deck area and locate footing.

Square with string

Attach string to ledger and/or batterboards.
Batterboards go just outside perimeter corners of the deck.
Use the 3-4-5 method to get a 90 degree angle in one corner.

Install posts

Footing/posthole depth is dictated by local codes.
Check with local utility companies to make sure deck construction will not disturb piping or wiring.

Installation Checklist

Post bracing

Brace posts as dictated by local codes.

Attach beams to posts

Determine the desired deck floor height on the posts.

Determine height for securing the top of the beam to the post.

Attach joists

Joists are attached to ledger board with joist hangers or by toenailing.

Determine where blocking will go and snap a chalk line, but make sure to stagger pieces for ease of nailing.

Lay decking

Attach boards "bark side up" to minimize cupping and warping.

The deck boards can be trimmed after they are installed.

Railings

Railings must be firmly attached to the framing members of the deck.

Check for local code restrictions on railings.

Stairs

Check local codes on stair restrictions.

Measure the rise and run of the stairs.

Multi-level decks

When planning a multi-level deck, for aesthetics make one deck larger than the other.

Tools Required & Tips for Success

Tools Required:

Carpenter's level	Hearing protection	Ruler
Carpenter's square	Hammer	Safety glasses
Chalk line	Hand saw	Screwdrivers
Chisel	Hoe and hose (to mix concrete)	Shims or spacers
Circular saw	Ladder	Shovel
Claw hammer	Line	Socket wrench
Combination square	Mallet	Stakes or batter boards
Crescent wrench	Nail set	String
Drills and bits	Pencils	Tamper
Dust mask	Pick	Tape measure
Extension cord	Plumb bob	Transit
Framing square	Post hole digger	Tool belt
Gloves	Rafter square	Two foot level

Tips for success:

1. When cutting or drilling wood, always wear eye protection to prevent injury from flying wood particles
2. When cutting lumber, a fabric breathing mask will help to avoid ingestion of the dust. Wear gloves as the surface is rough and can cause splinters.
3. For outdoor projects, nails and other hardware should be hot-dipped zinc-coated or equally well-protected material to keep them from rusting.
4. To help prevent splitting, drill pilot holes in each piece of lumber before nailing or screwing.
5. Make sure to treat your deck to prolong its lifespan.
6. Before you apply a finish on your deck, test for moisture by sprinkling the surface of a small area of the deck with water. If the droplets bead up, the wood is still wet. Wood that is dry enough for treatment will quickly soak up the water.
7. Deck finishes come in both water and oil based. While oil-based finishes penetrate deeper into the wood, water-based products are easier to clean up and are more forgiving in damp conditions.
8. When applying finish or cleaner to your deck, protect surrounding vegetation by wetting with a hose and covering with plastic.
9. Invest in a pair of kneepads if you are doing floor jobs or working on a deck.
10. Dispose of scraps in the regular trash or take to a landfill - never burn.

"How to Guide" Download Information

If you have not read our deck building article, read it at [Lowes.com/YourDeck](https://www.lowes.com/YourDeck)

**Below are the Specifications And Materials
that you have selected for your deck.**

Overview	Number of Levels: 1 Total Square Feet: 242	Footer Depth: 30" Live Load: 43 psf Dead Load: 10 psf
-----------------	---	---

Component	Size	Wood Type
Joists	2 x 6	Top Choice Treated
Beams	2 x 6	Top Choice Treated
Posts	4 x 4	Top Choice Treated
Decking	5/4 x 6	Pressure Treated Standard Decking
Railing		Pressure Treated Railing
Bench	24" x 17"	Pressure Treated Standard Decking
Lattice		None

FooterDepth	30"	Live Load	43 psf
		Dead Load	10 psf

Item Numbers May Vary By Location

Some Items May Not Be Available In All Locations

Material List

Lumber Materials		
Item Number	Quantity	Description
6715	11	2X6X20 ACQ TREATED
36333	1	2X6X14 TOP CHOICE STRUCT HF ACQ
24661	6	2X6X8 TOP CHOICE STRUCT HF ACQ
4643	4	3-STEP STRINGER #1 WATER REPELENT
101681	1	2X4X14 TOP CHOICE DECKING HF ACQ
29153	6	2X4X16 TOP CHOICE DECKING HF ACQ
157780	23	4X4X48" NOTCHED DECK POST HF ACQ
29130	1	2X4X8 TOP CHOICE DECKING HF ACQ
7951	98	2X2X42" BALUSTER ANGLE BOTH END
30180	8	2X6X10 TOP CHOICE STRUCT HF ACQ
21210	23	5/4X6X8 STD ACQ TREATED
5665	23	5/4/6X16.40 STDPT DKG WTR REPE
121	3	4X4X6 #2 .40 ACQ TREATED
21565	1	5/4X6X10 STD ACQ TREATED
29914	1	4X4X8 STD&BTR STRUCT POST HF ACQ

Other Materials			
Item Number	Quantity	Unit	Description
2411	15	1	4X4 2-SIDE POST ANCHOR TZ (14354)
10385	21	80	CONCRETE MIX 80# QUIKRETE
70664	15	1	1/2"X6 HDG ANCHOR BOLT WASHER/NUT
69262	2	5	NAIL COMMON GALV 5 LB 10 D
63449	120	1	GALV ROUND WASHER 1/2"
67357	60	1	GALV CARRIAGE BOLT 1/2 X 8
67342	60	1	GALV 1/2 HEX NUT
14328	44	1	XTENDED RAFTER TIE RT-15
69138	11	1	NAIL COMMON GALV 1LB 8D
68408	2	1	JOIST HGR.NAIL 1 LB 1-1/2"NA111CD
21993	18	1	HURR ANCHOR, 6.5X1.5TZ DBL PLATE TIE
95991	16	1	LUS26Z ZMAX 2X6 JOIST HANGER
124475	1	5	5LB N10D HOT-DIP GALVINIZED NAIL
2235	6	1	FIELD ADJ FR ANGLE 4-5/8TZ
1411	4	1	LSU26-R 2X6 SLOPE/SKEW HANGER
49117	1	1	1.20GL WATERGUARD OLYMPIC (85917)
11347	46	1	4X4 DECK POST TIE TZ (14360)
41196	4	1	3/8" HEX NUT GALVANIZED (25) PP
41706	8	1	3/8" FLAT WASHER GALV (25) PP
67353	92	1	GALV CARRIAGE BOLT 3/8 X 8
69264	2	5	NAIL COMMON GALV 5 LB 16 D

Beam Layout Level 1

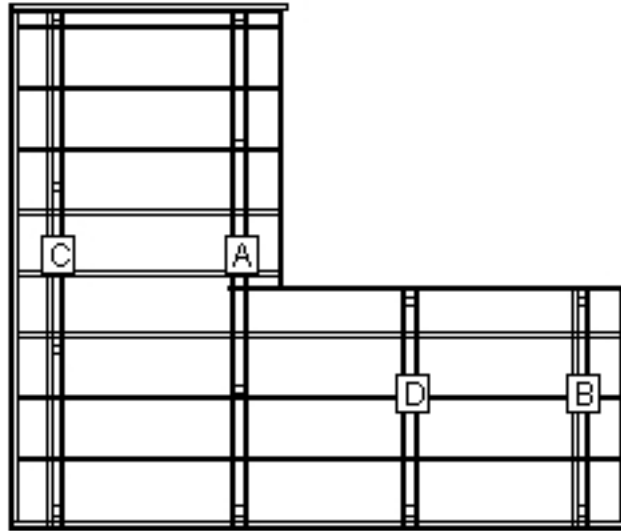

BEAM LABEL	BEAM LENGTH	POST COUNT	POST SPACING
A	16' 9"	5	3' 11 1/2"
B	7' 9"	3	3' 4 3/4"
C	16' 9"	4	5' 3 1/4"
D	7' 9"	3	3' 4 3/4"

Materials Cut List: Level 1

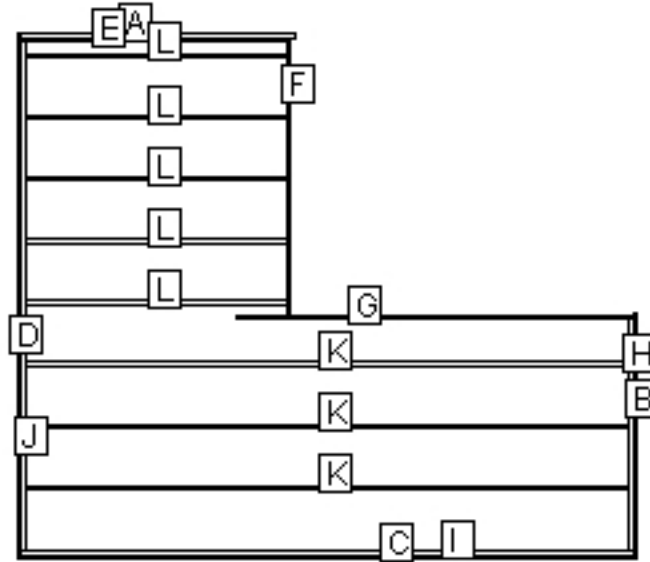

LABEL	NAME	QTY	LENGTH	BEVELS	LABEL	NAME	QTY	LENGTH	BEVELS
A	Fascia	1	9'	F45 S45	G	Outer Joist	1	12' 9 3/4"	
B	Fascia	1	8'	F45 S45	H	Header	1	7' 6"	
C	Fascia	1	20' 1"	F45 S45	I	Outer Joist	1	19' 10"	
D	Fascia	1	17'	F45 S45	J	Header	1	16' 6"	
E	Outer Joist	1	8' 9"		K	Joist	3	19' 7"	
F	Header	1	9'		L	Joist	5	8' 6"	

Cut Angles: L=Left, R=Right, F=Front, S=Side

Permit Page: Level 1

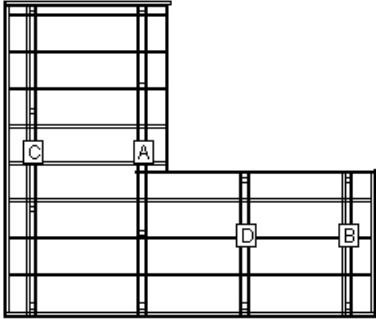

LOAD AND SUPPORT:

Your deck will support a 43 PSF live load.
Posts have 30" below ground support.

DECK AND POST HEIGHT:

You selected a height of 18" from the top of the decking to the ground level. The top of the deck support posts will therefore be 11.25" above ground level.

Joists:

Set joists on top of beams, 24"; center to center.

Stress Analysis: Level 1

Component	PSF
Joist Deflection	214
Joist Bending	52
Joist Shear	65
Joist Compression	152
Beam Deflection	64
Beam Bending	64
Beam Shear	69
Bolt Shear	208
Post Stability	324

Warning: This may not be a final design plan. Variations in building codes, specific architectural considerations, or site conditions may require changes to this design. You are responsible for the final structural, code verification, material usage, and structural safety of this design. Be sure to check and verify the design with your architect, engineer and building inspector.

Lowe's is a supplier of material only. Lowe's does not engage in the practice of engineering, architecture, or general contracting. Lowe's does not assume any responsibility for design, engineering, or construction; for the use of installation of materials; or for compliance with any building code or standard of workmanship. Always refer to information on fastener packaging for use with pressure treated lumber.

Preferences: Certain assumptions have been made in order to provide an accurate material quote for your Deck Project. Because local codes vary throughout the country, it is imperative that you check with your local municipality for compliance with local building codes. The following building practice assumptions have been made in providing the materials for your project:

Footer Depth:	30
Joist Cantilever:	12 inches
Joist Spacing:	24" center to center
Spacing Between Deck Planking:	1/8 inch
Stair Stringers:	10 inches
Deck Live Load:	40 psf
Deck Dead Load:	10 psf
Stairs Live Load:	40 psf
Stairs Dead Load:	10 psf

Be sure to check and verify the design with your architect, engineer and building inspector.

Note: It is recommended that joist that meet on top of beams should be spliced with gussets. The gussets should be 2- by wood the same width at the joist and overlap by 6 inches on each side. These gussets should be held in place with 12 16d galvanized nails.

Handling Precautions for Pressure-Treated Wood

Disposal: Dispose of treated wood by ordinary trash collection. Treated wood should not be burned in open fires, stoves, fireplaces, or residential boilers because toxic chemicals may be produced as part of the smoke and ashes. Treated wood from commercial or industrial use (e.g construction sites) must be disposed of in accordance with state and Federal regulations, which may include burning only in commercial or industrial incinerators or boilers. Always refer to information on fastener packaging for use with pressure treated lumber.

Operating Conditions: Avoid frequent or prolonged inhalation of sawdust from treated wood. When sawing, sanding and machining treated wood, wear a dust mask. Whenever possible, these operations should be performed outdoors to avoid indoor accumulations of airborne sawdust from treated wood. (Lowe's in-store saws are equipped with a vacuum to minimize airborne sawdust).

Protection: When power-sawing and machining, wear goggles to protect eyes from flying particles.

Clean Thoroughly: Wear gloves when working with the wood. After working with the wood, and before eating, drinking, toileting, and use of tobacco products, wash exposed areas thoroughly.

Wash Separately: Because preservatives or sawdust may accumulate on clothes, they should be laundered before reuse. Wash work clothes separately from other household clothing.