

NOTICE

The purchaser agrees when purchasing this plan (the "Plan"):

- 1) the purchaser has acquired the right to build or construct the Project or project set out in the Plan for personal use only and not for any commercial use;
- 2) reproduction of the Plan in whole or in part by any means whatsoever is strictly prohibited. The Homeplan should not be liable for any willful misuse or negligent use of this plan, the Project or any tools used to construct the Project or for any loss or damage resulting therefrom.

NOTES: Read all instructions before beginning
 Carpenters Glue should be used to reinforce all joints
 Set all nails
 Dimensions in brackets denote millimeters

Directions

- 1) Lay out your material on the workbench, or on sawhorses, as outlined in the cutting diagram (Fig 1 and 2). Draw out all parts exactly as illustrated, including the letter designations, in pencil. Ensure to leave a small space between cut lines to allow for the width of the saw. Before cutting, double check all measurements to ensure they are correct. Always cut on the waste side of the line. To prevent splitting when cutting across the grain, we recommend that you use masking tape on the edge before cutting.
- 2) Drill holes through pieces E as shown (Fig 3), with a 1/2" drill bit, remembering that one piece is a mirror image of the other. Glue and nail E to D, leaving a 3/8" gap on the top and bottom, with 1" finishing nails. Repeat for the other DE assembly, creating a mirror image. One end of each of the eight pieces E should have a 1/2" dowel (one end of each of the eight pieces E should have a 1/2" dowel) in the hole in position to allow C to slide back and forth, but not to come out once pieces K are attached. The other holes are for pegs F, to support shelf M at varying heights.

OVER

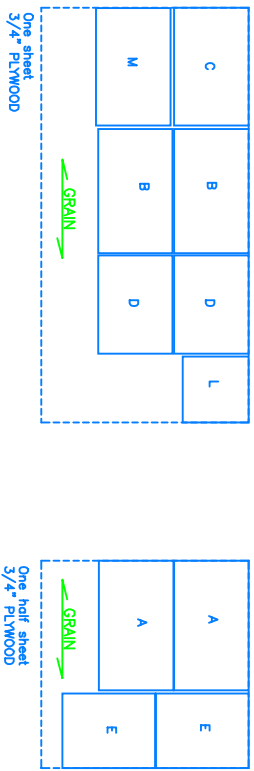

MATERIALS LAYOUT
 FIGURE 1

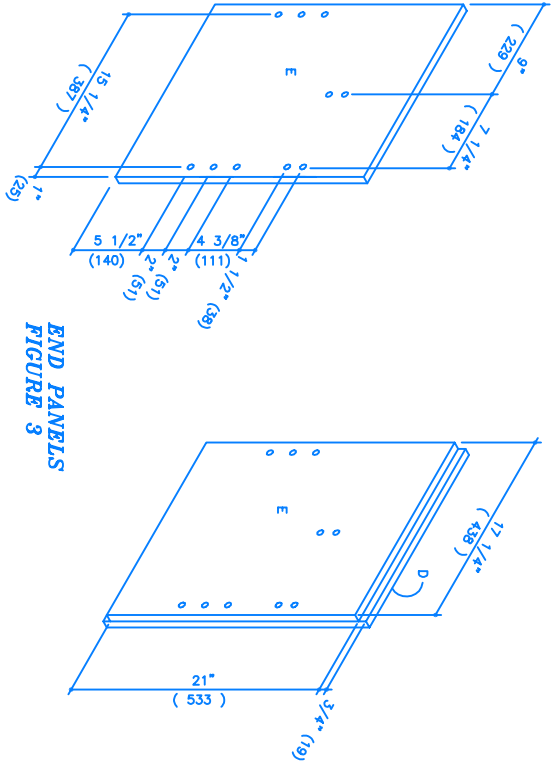
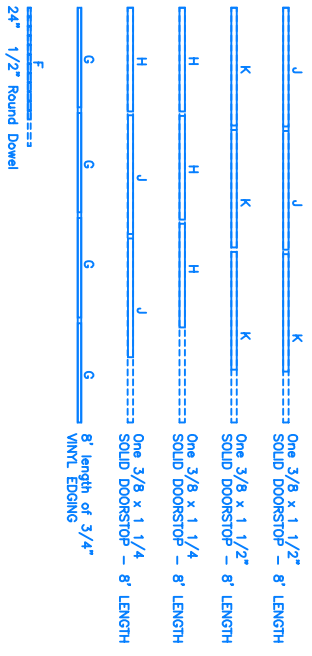

END PANELS
 FIGURE 3

CUTTING DIAGRAM
 FIGURE 2

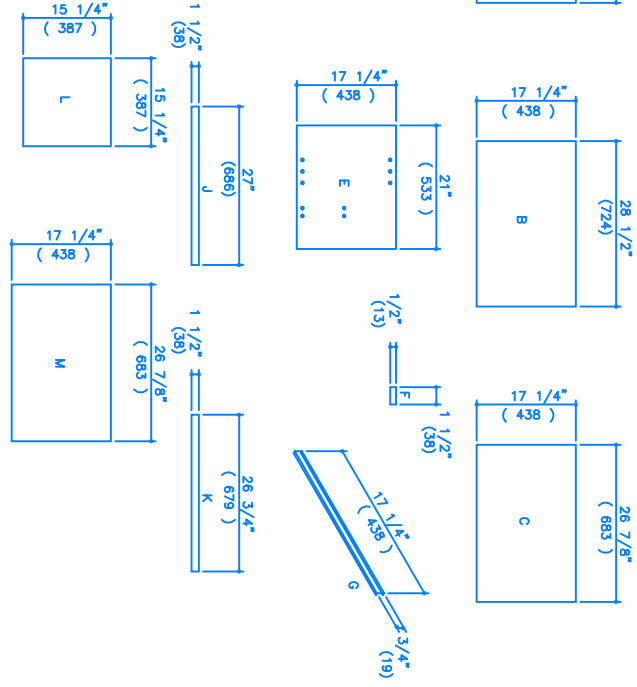

TV STAND - Project #315

MATERIALS LIST

- Approx. 1 lb. 2 1/2" nails
- Approx. 1/2 lb. 1 1/2" finishing nails
- Approx. 1/2 lb. 1" finishing nails
- One 4"x8" sheet 3/4" plywood
- One 4"x4" sheet 3/4" plywood
- Four 8" doortop (3/4"x1 1/2")

MATERIALS LIST

- 8" vinyl shelf edging (Optional)
- Four casters & hardware (Optional)
- One 8" length Edgetape (for stained project)
- Approx. Thirty 5/8" #8 finished screws (Optional)
- Sandpaper
- Carpenters glue

MATERIALS LIST

- One 24" length of 1/2" wood dowel
- Wood filler