

NOTICE

The purchaser agrees when purchasing this plan (the "Plan") that he or she understands the right to build or construct the object or project set out in the Plan (the "Project") for his/her/its personal use only and not for any commercial purpose. The Plan in whole or in part by any means whatsoever is strictly prohibited. Blueprints for the Handyman Project are not to be used for any other project. The Project is to be constructed by the purchaser or for his/her/its personal use only and not for any commercial purpose. The Project is to be constructed by the purchaser or for his/her/its personal use only and not for any commercial purpose. The Project is to be constructed by the purchaser or for his/her/its personal use only and not for any commercial purpose.

NOTE: Read all directions before beginning

Carpenter's glue should be used to reinforce all joints.
Set all nails, countersink all screws.
Dimensions in brackets denote millimeters

Directions

1) Lay out your material on the workbench, or on sawhorses, as outlined in the suggested material layout (Fig. 2). Chop out all ports exactly as indicated in the material layout. Ensure to leave a small space between cut lines to allow for the width of the saw. Before cutting, double check all measurements to ensure they are correct. We suggest that you tape along the edges of cutlines with masking tape to avoid splintering when cutting across the grain. Always cut on the waste side of the line. Wipe off any excess glue at each stage of the project. For cutting the rabbit in pieces B and X, you can use a table saw set to a depth of 1/2" and 3/8". The rabbits on pieces N are 3/8" deep by 3/4" wide. Test the depth of your blade on a scrap piece of wood before making the actual cut. For the doors in pieces N and P, measure up from the bottom of each cut. Set the depth to 1/4" and cut across each. Piece X must have two cuts and chisel out the waste. The cut on piece B is on the inside 80° edge.

OVER

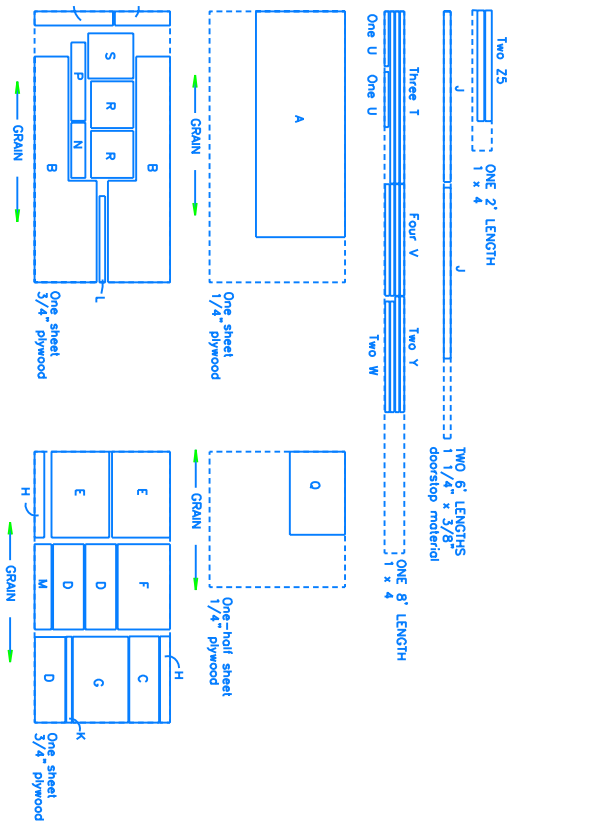

MATERIALS LAYOUT
FIGURE 1

DELUXE TELEVISION STAND – Project #304

MATERIALS LIST

One 4"x8" sheet 1/4" plywood, good both sides
Two 4"x8" sheets 3/4" plywood, good both sides
One 24"x48" sheet 1/4" plywood, good both sides
Two 6" doorstops (1 1/4"x3/8")
One 8" 1x4 (3/4"x3 1/2")
One 2" 1x4 (3/4"x3 1/2") Maple or Birch
24 edgetape

MATERIALS LIST

Sixteen shelf supports brackets
Approx. 1 lb. 1 1/4" finishing nails
Approx. 1/2 lb. 3/4" finishing nails
Approx. fifty 1 1/4" #8 flushhead screws
Two 16"x3/4" piano hinges & hardware
Two magnetic door latches & hardware
Two 18" side mounted drawer guides (1/2") & hardware

MATERIALS LIST

Four drawer pulls & hardware
Stain & varnish, or oil
Sandpaper
One lazy suson 6"x6" swivel

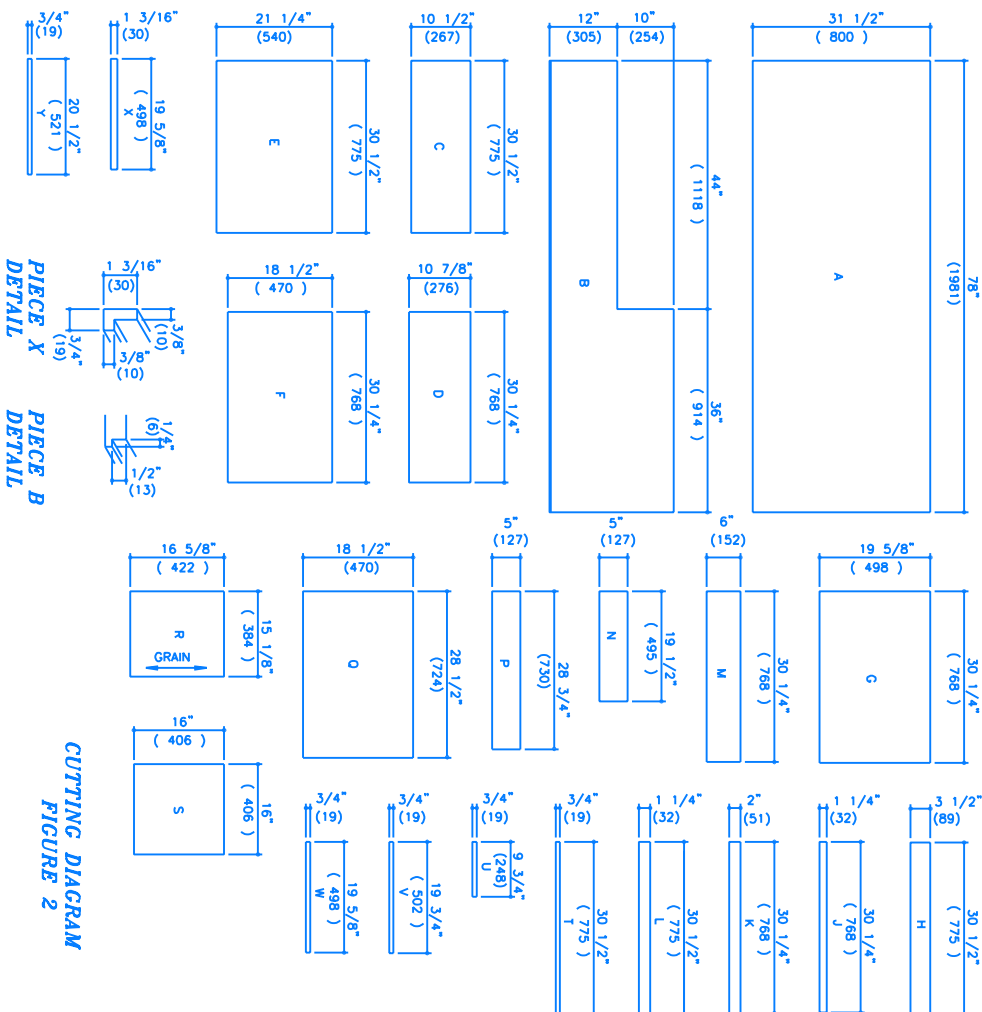

CUTTING DIAGRAM
FIGURE 2

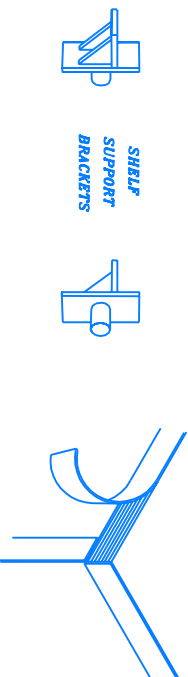

EDGE TAPE
ILLUSTRATION 2

DRILL DEPTH GAUGE
ILLUSTRATION 1

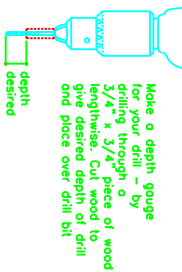

Note a depth gauge for your drill. By drilling through a 3/4" x 3/4" piece of wood lengthwise, cut wood to give desired depth of drill and place over drill bit desired depth.