

**NOTICE**

The purchaser agrees when purchasing this plan (hereinafter referred to as the "Plan") the right to build or construct the object or project set out in the Plan (the "Project") for his/her/its personal use only and not for any commercial use. The Plan in whole or in part by any means whatsoever is strictly prohibited. The purchaser shall not be liable for any willful misuse or negligent use of this plan, the Project or any tools used to construct the Project, or for any loss or damage resulting therefrom.

**NOTE: Read all directions before beginning.**  
 Carpenters glue should be used to reinforce all joints  
 Dimensions shown in brackets denote millimeters  
 Set all nails and countersink all screws.

**Directions**

- 1) Lay out your materials as outlined in the suggested plywood materials layout (Fig. 1), the 2x2 cutting requirements are found along side the instructions for assembling each component. Draw out all parts exactly as illustrated, including the letter designations, in pencil. Ensure to leave a small space between cut lines to allow for the width of the saw. Before cutting, double check all measurements to ensure that they are correct. Always cut on the waste side of the line.

**NOTE: DO NOT PRE-DRILL HOLES**

Cut one end of D3, D4, D5, E3, E4 and E5 at 7 degrees and both ends of D1 and E1 at 7 degrees; see (Fig. 2). The measurements for each is on the long side of the piece. Use the miter box for these cuts. Cut out the doorways in pieces E9 and E12 with a jig saw or keyhole saw. Note: The insulation between the studs before nailing interior panelling to walls. Insulation should fit so that all wall cavities are filled.

- 2) Component A. Layout pieces A2 between pieces A1. (Fig. 3). Nail through pieces A1 into the ends of pieces A2 using 2 1/2" common nails. Place piece A5 on this assembly and nail to pieces A1 and A2 using 1 1/2" common nails. Place pieces A3 under the assembly, one under each piece A1 with a 2" overhang all around pieces A1. (Fig. 11). Nail through pieces A1 and A5 into pieces A3 using 2 1/2" common nails. Place insulation. Place piece A4 on this assembly and nail to pieces A1 and A2 using 1 1/2" common nails.

- 3) Component B. Cut piece B1 with a 7 degree angle along top edge. Lay out the three pieces B3 between pieces B2 and B1 with the 7 degree edge of piece B1 on the top outside edge. (Fig. 4). Nail through pieces B1 and B2 into the ends of pieces C3 using 2 1/2" common nails. Place B3 on the assembly with B1 flush with B2 and a 2 1/4" overhang post the outside edges of pieces B1, B2 and B3 using 1 1/2" common nails. Invert the assembly. Place insulation and place piece B5 on top flush with outside edges on B1, B2 and B3s. Nail to pieces B1, B2 and B3 using 1 1/2" common nails.

- 4) Component C. Cut piece C1 with a 7 degree angle at one side. Lay out the three pieces C3 between pieces C2 and C1 with the 7 degree end of piece C1 on the top outside edge sloping toward C4. (Fig. 5). Nail through pieces C1 and C2 into the ends of pieces C3 using 2 1/2" common nails. Place piece C4 on this assembly with the edges of pieces C4 flush with C1 and C2 and a 2 1/4" overhang post the outside edges of pieces C3. Nail to pieces C1, C2 and C3 using 1 1/2" common nails. Invert the assembly, place insulation and place piece C5 on the top flush with outside edges on C1, C2 and C3s. Nail to pieces C1, C2 and C3 using 1 1/2" common nails.

**OVER**

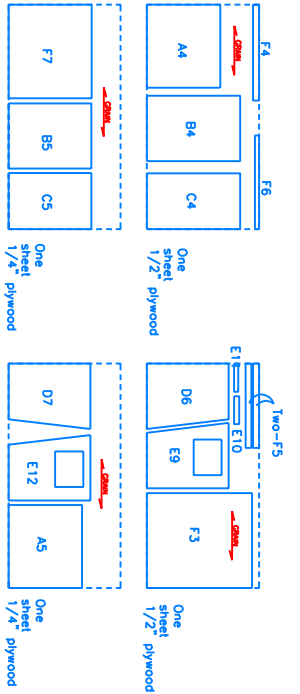

**FIGURE 1**  
**PLYWOOD MATERIAL LAYOUT**

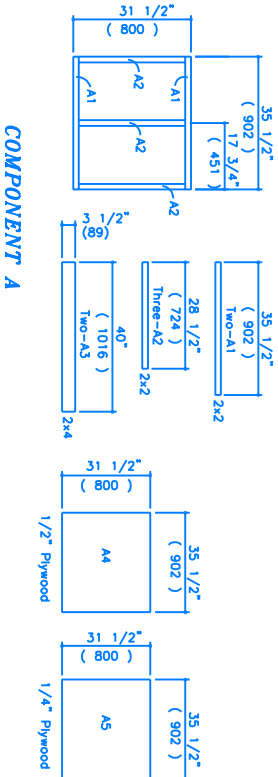

**FIGURE 3**

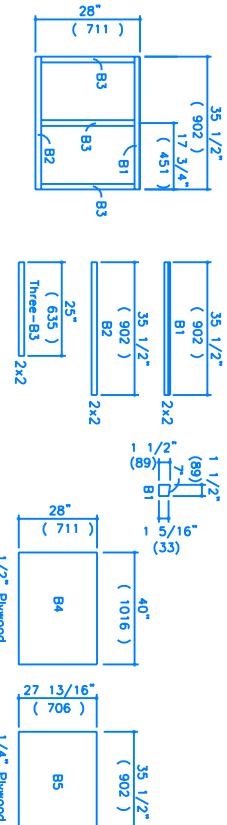

**FIGURE 4**

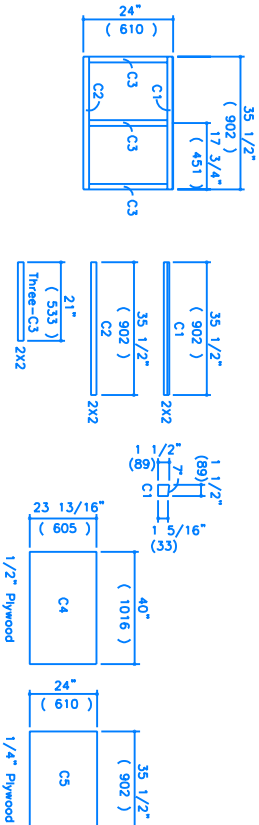

**FIGURE 5**

End cut required for one end of pieces D1, D2, D3, D4, D5, E3, E4, E5, E6, E7, E8, E9, E10, E11, E12. (Note: dimensions for the above pieces are to the long sides)

**FIGURE 2**

**MATERIALS LIST**

Approx. 1 lb. 2 1/2" Common nails  
 Approx. 1 lb. 3" Common nails  
 Approx. 1 lb. 1 1/2" nails  
 Two sheets 1/2" plywood  
 Two sheets 1/4" plywood  
 One B 2x4 (1 1/2" x 3 1/2")  
 Eleven B 2x2 (1 1/2" x 1 1/2")

**MATERIALS LIST**

Oil base joint  
 Two 3" butt hinges and hardware  
 36" x 12" piece of carpet  
 12" of weatherstripping  
 Caulking

**TOOLS**

Table Saw and Measuring Tape  
 Pencil or Hand Drill  
 Power or Hand Drill  
 1/4" drill bit  
 Hammer and Screwdrivers  
 Square and Nail Set  
 Point Brush and Putty Knife

5) Component D. Lay out pieces D3, D4 and D5 between pieces D1 and D2 with the 7 degree angle matched to piece D1. (Fig 6). Nail through piece D1 and D2 into the ends of pieces D3, D4 and D5 using 2 1/2" common nails. Place piece D6 on top flush with outside edges on D1, D2, D3 and D5. Nail to pieces D1, D2, D3, D4 and D5 using 1 1/2" common nails. Place insulation. Invert the assembly and place piece D7 on top flush with outside edges in D1, D2, D3. Nail to pieces D1, D2, D3, D4 and D5 using 1 1/2" common nails.

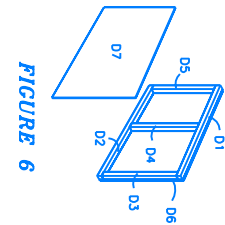

FIGURE 6

6) Component E. Lay out pieces E3, E4 and E5 between pieces E1 and E2 with the 7 degree angle matched to piece E1. (Fig 7). Nail through pieces E1 and E2 into the ends of pieces E3, E4 and E5 using 2 1/2" common nails. Place piece E7 on top of both pieces E6 and nail piece E7 to piece E6 with 2 1/2" common nails. Place piece E8 between pieces E6 with the top piece E8 located 4 1/4" from the bottoms of pieces E6. Nail through pieces E6 into the ends of piece E8 using 2 1/2" common nails. Fit this assembly between pieces E4 and E5 with bottom of pieces E6 on piece E2. Nail through pieces E3 and E4 into piece E6 using 2 1/2" common nails. Nail through piece E2 into the ends of pieces E6 using 2 1/2" common nails. Nail through piece E8 on top of piece E6 using 2 1/2" common nails. Invert the assembly place insulation and place piece E12 on top flush with outside edges on E1, E2, E3, E4 and E5 using 1 1/2" common nails. Invert the assembly place insulation and place piece E12 on top flush with outside edges on E1, E2, E3 and E5. Nail to pieces E1, E2, E3, E4 and E5 using 1 1/2" common nails. Cut a strip of carpet 12" wide x 31 3/4" long. Make 12 1/2" cuts in each end of the carpet alternating positions of the cuts. (Fig 8). Fold the carpet around three sides of piece E11 and place in the doorway with E11 flush with piece E7 with carpet between them. (Fig 9). Nail through E11, the carpet and into E7 with 1 1/2" common nails. Nail on piece E10 to piece E8 using 1 1/2" common nails.

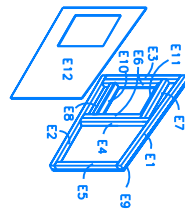

FIGURE 7

7) Component F. Lay out pieces F2 between pieces F1. (Fig 10). Nail through pieces F1 into the ends of pieces F2 using 2 1/2" common nails. Place piece F7 on this assembly and nail to pieces F1 and F2 using 1 1/2" common nails. Invert, place insulation and place piece F3 on this assembly with a 2 1/2" overlap on all edges and nail to pieces F1 and F2 using 1 1/2" common nails. Place pieces F5 squarely on pieces F2 and nail pieces F5 on piece F2 using 1 1/2" nails. Place piece F4 squarely on piece F1 and nail to piece F1 using 1 1/2" common nails.

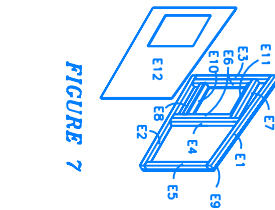

FIGURE 8

8) Place wall B on piece A3 square with piece A1. (Fig 11). Nail through the frame of wall B into piece A1 using 3 1/2" common nails. Repeat for wall C. Place nail E between nails B and C. Nail through frame of wall E into piece A1 using 2" common nails. Repeat for wall D. Nail through the edge of wall B into walls D and E using 1 1/2" common nails. Repeat for wall C.

**On materials**

9) Caulk all interior joints and joint interior of doghouse with three coats of oil based paint. After the paint dries apply door weatherstripping between hinged roof and top of walls. Paint or stain exterior of doghouse. Set roof on doghouse and attach roof to house with two 3" built hinges screwed to panel C. The hinged roof allows for easy access, allowing you to replace your dog's bedding with ease.

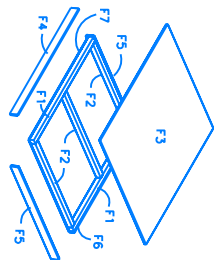
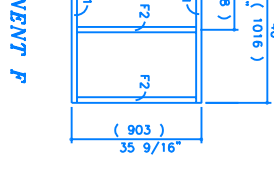
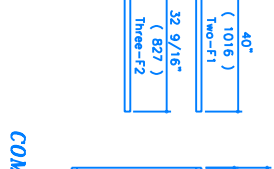
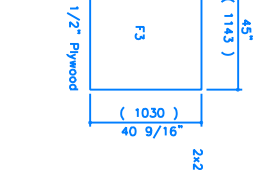
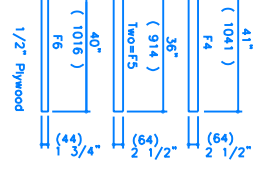
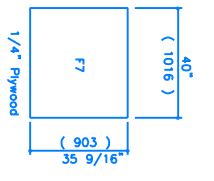
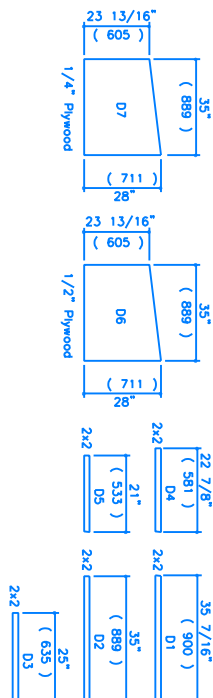

FIGURE 10



COMPONENT F



COMPONENT D

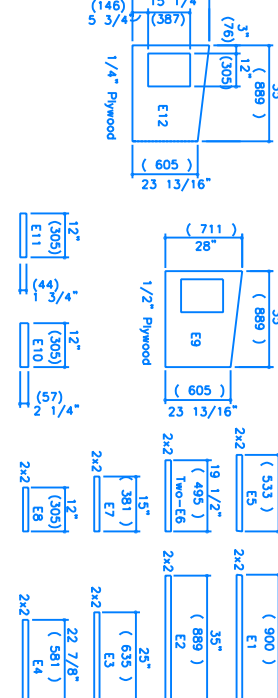

COMPONENT E

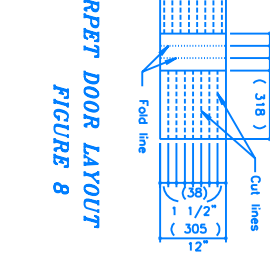
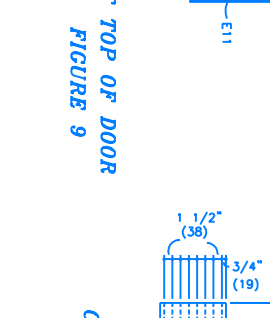
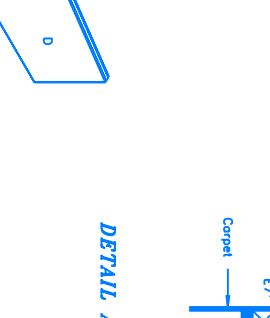
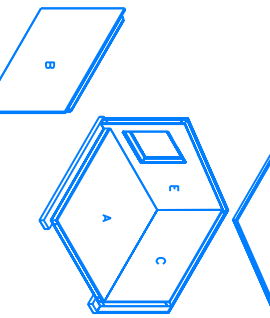
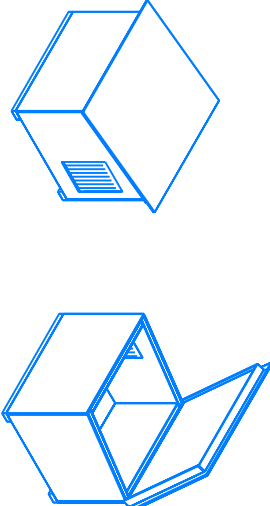
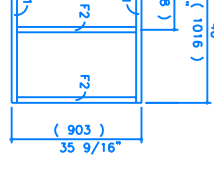
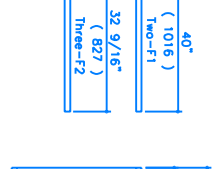
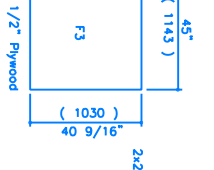
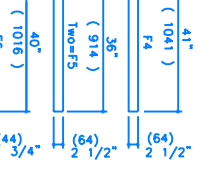
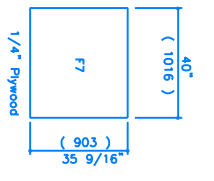

DETAIL AT TOP OF DOOR

FIGURE 9

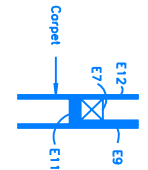

CARPET DOOR LAYOUT

FIGURE 8

